

TIPPMANN™

CUSTOM PRO™

CUSTOM PRO™ RESPONSE™

CUSTOM PRO™ WITH E-TRIGGER™

Owner's
Manual

Le Manuel du
Propriétaire

Manual
del Usuario





WARNING

THIS IS NOT A TOY. MISUSE MAY CAUSE SERIOUS INJURY OR DEATH. EYE, FACE AND EAR PROTECTION DESIGNED FOR PAINTBALL MUST BE WORN BY THE USER AND ANY PERSON WITHIN RANGE. WE RECOMMEND AT LEAST 18 YEARS OLD TO PURCHASE. PERSONS UNDER 18 MUST HAVE ADULT SUPERVISION WHEN USING THIS PRODUCT. READ THE OWNER'S MANUAL BEFORE USING THIS PRODUCT.



AVERTISSEMENT

CE N'EST PAS UN JOUET. L'USAGE IMPROPRE PEUT CAUSER LA BLESSURE SÉRIEUSE OU LA MORT. LA PROTECTION POUR LES YEUX, LE VISAGE ET LES OREILLES CONSTRUITE POUR LA BALLE DE PEINT DOIT ÊTRE PORTER PAR L'UTILISATEUR ET N'IMPORTE QUELLE PERSONNE DANS LE CHAMP DE TIR. NOUS RECOMMANDONS QU' ON A DIX – HUIT ANS AU MOINS POUR L'ACHETER. LES PERSONNES SOUS L'ÂGE DE DIX – HUIT ANS DOIVENT AVOIR LA SUPERVISION D' UN ADULTE QUAND ON EMPLOIE CE PRODUIT. IL FAUT LIRE TOUT DE CE MANUEL AVANT DE L'UTILISER.



ADVERTENCIA

ESTO NO ES UN JUGUETE. UN USO INAPROPIADO PUEDE CAUSAR SERIAS HERIDAS O MUERTE. OJOS, CARA Y OIDOS DEBEN SER PROTEGIDOS TODO EL TIEMPO, CON LA PROTECCIÓN DISEÑADA PARA PAINTBALL TANTO POR JUGADORES COMO POR CUALQUIER PERSONA QUE ESTE EN EL RADIO DE ALCANCE. RECOMENDAMOS AL MENOS 18 AÑOS PARA LA COMPRA Y USO. LAS PERSONAS MENORES DE 18 AÑOS DEBEN USAR ESTE PRODUCTO BAJO LA SUPERVISIÓN DE UN ADULTO. ANTES DE USAR ESTE PRODUCTO LEA EL MANUAL DEL USUARIO.



WARNING

SAFETY IS YOUR RESPONSIBILITY

READ, FAMILIARIZE YOURSELF AND ANY OTHER USER OF THIS MARKER WITH THE SAFETY INSTRUCTIONS IN THIS MANUAL. FOLLOW THESE INSTRUCTIONS WHEN USING, WORKING ON, TRANSPORTING OR STORING THIS MARKER.



ALWAYS KEEP TRIGGER SAFETY IN SAFE MODE UNLESS FIRING AS DETAILED IN INSTRUCTIONS ON PAGE 4.



ALWAYS KEEP BARREL SLEEVE INSTALLED WHEN NOT IN SHOOTING SITUATION AS DETAILED IN INSTRUCTIONS ON PAGE 2.



AVERTISSEMENT

SÉCURITÉ EST VOTRE RESPONSABILITÉ

IL FAUT LIRE, VOUS FAMILIARISER ET TOUS LES AUTRES UTILISATEURS DE CE MARQUEUR AVEC LES INSTRUCTIONS DE SÉCURITÉ DANS CE MANUEL. SUIVEZ CES INSTRUCTIONS QUAND VOUS UTILISEZ, TRAVAILLEZ SUR, TRANSPORTEZ, OU ENTREPOSEZ CE MARQUEUR.



IL FAUT TOUJOURS GARDER LA DÉTENTE DANS UNE MODE DE SÉCURITÉ SAUF QUAND ON TIRE COMME DÉTAILÉ DANS LES INSTRUCTIONS À LA PAGE 4.



IL FAUT TOUJOURS GARDER LA MANCHE DU CANON INSTALLÉE QUAND ON NE TIRE PAS COMME DÉTAILÉ DANS LES INSTRUCTIONS À LA PAGE 2.



ADVERTENCIA

LA SEGURIDAD ES SU RESPONSABILIDAD

EL PROPIETARIO Y TODA PERSONA QUE VA A USAR ESTE MARCADOR DEBE LEER Y FAMILIARISARCE CON LAS ISTRUCCIONES DE SEGURIDAD EN ESTE MANUAL. SIGA LAS INSTRUCCIONES DE USO, MANTENIMIENTO, TRANSPORTE Y ALMACENAJE DE ESTE MARCADOR.



MANTENGA SIEMPRE EL SEGURO DEL GATILLO ACTIVADO A MENOS QUE SE A NECESARIO HACER DISPAROS. INMEDIATOS COMO SE VE EN LAS INSTRUCCIONES EN LA PÁGINA 4.



MANTENGA LA FUNDA DE SEGURIDAD INSTALADA CUANDO NO ESTE HACIENDO DISPAROS COMO SE ILUSTRÁ EN LA PÁGINA 2.



WARNING

THIS IS NOT A TOY. MISUSE MAY CAUSE SERIOUS INJURY OR DEATH. EYE, FACE AND EAR PROTECTION DESIGNED FOR PAINTBALL MUST BE WORN BY THE USER AND ANY PERSON WITHIN RANGE. WE RECOMMEND AT LEAST 18 YEARS OLD TO PURCHASE. PERSONS UNDER 18 MUST HAVE ADULT SUPERVISION WHEN USING THIS PRODUCT. READ THE OWNER'S MANUAL BEFORE USING THIS PRODUCT.



WARNING

BARREL SLEEVE INSTALLATION

• EXCEPT WHEN YOUR MARKER IS IN USE, ALWAYS MAKE SURE THAT THE TRIGGER SAFETY IS IN SAFE MODE (SEE INSTRUCTIONS ON PAGE 4), AND THE BARREL SLEEVE IS PROPERLY INSTALLED ON YOUR MARKER AS SHOWN BELOW.

1) SLIDE BARREL INTO SLEEVE AND LOOP CORD OVER TOP OF RECEIVER AND POSITION AT BACK OF GRIP AS SHOWN BELOW.



2) PINCH CORD LENGTH ADJUSTOR BUTTON AND HOLD TO BACK OF GRIP AS YOU PULL CORD THROUGH IT UNTIL ADJUSTOR IS SNUG AGAINST BACK OF GRIP, THEN RELEASE BUTTON.

3) CHECK TO BE SURE YOU LEAVE ENOUGH CORD ELASTICITY TO PULL CORD/ADJUSTOR UP OVER TOP OF MARKER TO REMOVE BARREL SLEEVE FOR FIRING.



4) AFTER CORD LENGTH IS ADJUSTED, LOCK CORD LENGTH BY TYING A KNOT IN THE CORD AGAINST THE BACK OF THE ADJUSTOR AS SHOWN.

TIPPMANN™

2955 Adams Center Road, Fort Wayne, IN 46803 USA
P) 260-749-6022 • F) 260-749-6619
www.tippmann.com

ENGLISH

CONGRATULATIONS on your purchase of your Tippmann™ paintball marker. We believe our CUSTOM PRO™ line of markers be the most accurate and durable paintball markers available, and proudly manufactured in the USA. All Tippmann™ CUSTOM PRO™ markers will give many years of dependable service if cared for properly.

Please take time to read this manual thoroughly and become familiar with your CUSTOM PRO™ model's parts, operation, and safety precautions before you attempt to load or fire this marker. If you have a missing or broken part or need assistance, please contact Tippmann™ Consumer Relations at 1-800-533-4831 for fast friendly service.

TABLE OF CONTENTS

Warning/Caution	2
Warning/Caution Barrel Sleeve Installation	2
Warning/Liability Statement	4
Safety is your Responsibility	4
Safe Mode = Turning The Safety On	4
Fire Mode = Turning The Safety Off	4
Getting Started	6
1. Prepare Marker for Air Supply Cylinder Installation	6
2. Air Supply Cylinder Installation	6
3. Hopper	7
4. Rate of Fire Adjustments and Troubleshooting	7
5. Velocity Adjustment	7
6. Rear Sight Adjustment	7
Schematic	12-13
Unloading Your Marker	14
Air Supply Cylinder Removal	14
Cleaning & Maintenance	14
Marker Disassembly	15
Repairing Air Supply Leaks	16
Storage	16
Specifications	17
Warranty and Repair Policy	18
Warranty or Repair Procedure	18
Warranty Registration	18

Warning/Liability Statement

This marker is classified as a dangerous weapon and is surrendered by Tippmann Sports, LLC with the understanding that the purchaser assumes all liability resulting from unsafe handling or any action that constitutes a violation of any applicable laws or regulations. Tippmann Sports, LLC shall not be liable for personal injury, loss of property or life resulting from the use of this weapon under any circumstances, including the intentional, reckless, negligent or accidental discharges.

All information contained in this manual is subject to change without notice. Tippmann Sports, LLC reserves the right to make changes and improvements to products without incurring any obligation to incorporate such improvements in products previously sold.

If you as a user do not accept liability, Tippmann Sports, LLC requests you do not use a Tippmann Sports, LLC marker. By using this paintball marker you release Tippmann Sports, LLC of any and all liability associated with its use.

Safety Is Your Responsibility!



WARNING

TRIGGER SAFETY ACTIVATION

- EXCEPT WHEN YOUR MARKER IS IN USE, ALWAYS MAKE SURE THAT THE BARREL SLEEVE IS INSTALLED (SEE PAGE 2) AND THE TRIGGER SAFETY IS IN SAFE MODE WHICH DISABLES THE TRIGGER.



TO TURN ON THE SAFETY (SAFE MODE): PUSH THE SAFETY IN AS SHOWN ABOVE.

TO TURN SAFETY OFF (FIRE MODE): PUSH SAME BUTTON ON OPPOSITE SIDE OF RECEIVER.

FAMILIARIZE YOURSELF WITH SAFETY...

The ownership of this weapon places upon you the total responsibility for its safe and lawful use. You must observe the same safety precautions as you would any firearm to

Safety Is Your Responsibility (continued from page 4)

assure the safety of not only yourself but everyone around you. The user should at all times use caution when using this marker. The sport of Paintball will be viewed and judged upon your safe and sportsmanlike conduct. Always remember that the game of Paintball can only survive and grow if it remains SAFE!

- Do not load or fire this marker until you have completely read this manual and are familiar with its safety features, mechanical operation and handling characteristics.
- Handle this and any marker as if it were loaded at all times.
- Keep your finger off the trigger until ready to shoot.
- Do not look down the barrel of a paintball marker. Accidental discharge into the eyes may cause permanent injury or death.
- Keep the marker on safe until ready to shoot.
- Keep the barrel sleeve installed on marker when not shooting.
- Never point the marker at anything you do not intend to shoot.
- Never fire your marker at anything you do not intend to shoot because there may be balls or foreign debris lodged in the chamber, barrel and / or the marker valve.
- Do not shoot at fragile objects such as windows.
- Never fire your marker at personal property of others, the paintball can stain the paint of automobiles and houses.
- Always keep the muzzle pointed down or in a safe direction, even if you stumble or fall.
- Eye, face and ear protection designed specifically to stop paintballs in the form of approved goggles and full face mask should be worn by the user and any person within range.
- Never shoot at a person who is not protected by eye, face and ear protection designed for paintball.
- Pressurize and load the marker only when the marker will be immediately used.
- NOTE: Before storing or disassembling be sure to remove paintballs and air supply. Completely empty the hopper, point your marker in a safe direction, fire several times to be sure there are no balls lodged in the chamber and/or barrel or air left in the marker. Install barrel sleeve (see page 2).
- Store the marker unloaded and degassed in a secure place.
- Familiarize yourself with any warnings and instructions listed on the air supply cylinder. Contact the air supply cylinder manufacturer with any questions.

Safety Is Your Responsibility (continued from page 5)

- Do not field strip or otherwise disassemble this marker while it is pressurized with air supply.
- Dress appropriately when playing the game of paintball. Avoid exposing any skin when playing the game of paintball. Even a light layer will absorb some of the impact and protect you from the paintballs.
- Keep exposed skin away from escaping gas when installing or removing air supply cylinder or if the marker or air supply is leaking. Compressed air, CO₂, and nitrogen gasses are very cold and can cause frostbite under certain conditions.
- Use only .68 caliber paintballs, never load or fire any foreign objects.
- Avoid alcoholic beverages before and during the use of this marker. Handling markers while under the influence of drugs or alcohol is a criminal disregard for public safety.
- Avoid shooting an opponent at point blank, 6 feet or less.
- Familiarize yourself with instructions listed on air supply cylinder or adaptor. Contact the air supply cylinder or adaptor manufacturer with any questions.
- Always measure your marker's velocity before playing paintball and never shoot at velocities in excess of 300 feet per second (see instructions on page 7).

Getting Started

STEP 1) Prepare Marker for Air Supply Cylinder Installation

- For Model: Custom Pro™ With E-GRIP™ - You must first install battery (see instructions on page 9 before performing STEP 2).
- For Custom Pro™ and Custom Pro™ Response™ go to STEP 2.

STEP 2) Air Supply Cylinder Installation

- Do not pressurize a partially assembled paintball marker.
- First install barrel sleeve (see instructions on page 2).
- Next put trigger safety in Safe Mode (see instructions on page 4).
- Next you need to cock the marker by sliding the bolt handle all the way back until it locks into place. Always keep marker in the cocked position when air supply is attached to marker. This will help prevent an accidental discharge.
- To install the air supply cylinder, lubricate the cylinder valve o-ring with a little gun oil then insert the cylinder valve end into the air supply adapter at the back end of the marker grip. Twist the cylinder clockwise into the marker until it stops. Adjust the butt plate if necessary. Your marker is ready to fire once you switch to Fire Mode from Safe Mode. If the tank is full and you do not hear the air supply engage, the pin valve could be too short or the pin valve seal is damaged.

STEP 3) Hopper

- Barrel Sleeve must be installed (see page 2) and safety in Safe Mode (see page 4) before filling the hopper.
- Make sure that the feed elbow and hopper are clean and free of any sharp edges to keep paintballs feeding into the marker smoothly.
- Install the hopper neck into the feed elbow of your marker and tighten the hopper down with a 3/16" allen wrench.

NOTE: Do not overtighten or the elbow may break. With the barrel sleeve installed and safety in Safe Mode, you are now ready to load your hopper with paintballs. Fill hopper and only remove barrel sleeve and turn off the safety when ready to shoot.

STEP 4) Rate of Fire Adjustments and Troubleshooting

- For RESPONSE™ marker - complete Tuning The Response Trigger Rate of Fire instructions on page 8 then go to STEP 5.
- For E-TRIGGER™ marker - complete E-GRIP Tuning and Operating Instructions on page 9.
- For CUSTOM PRO™ marker - Go to STEP 5.

STEP 5) Velocity Adjustment

Each time you play paintball, the velocity of your paintball marker should be checked with a chronograph, an instrument for measuring velocity, prior to playing paintball to verify that the marker's velocity is set below 300 feet per second or less if required by playing field.

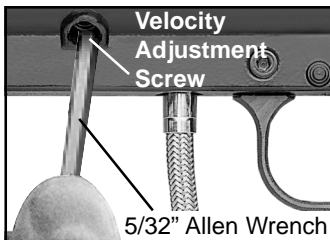

To adjust the velocity use the 5/32" allen wrench included with your marker. The velocity adjustment screw is located on left side receiver. To adjust the velocity down, turn the screw inward or clockwise. To turn the velocity up, turn the screw out or counterclockwise. Do not remove velocity screw.

NOTE: You must turn the velocity screw all the way in before doing any disassembly.

STEP 6) Rear Sight Adjustment

If your paintball is hitting low, slide the rear sight back towards rear of marker. Do the opposite if paintball is hitting high.

Tuning The RESPONSE™ Trigger Rate of Fire

With a screwdriver, turn the Flow Control Adjustor—

clockwise
to slow the
rate of fire



counterclockwise to increase
rate of fire to the
desired speed.

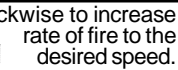
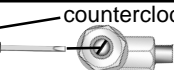

Tuning - Troubleshooting A:

If tuning the Response™ trigger produces little or no response in the rate of fire, reset the Flow Control as follows:

1) With marker properly unloaded (see page 14), begin adjusting rate of fire by turning flow control clockwise completely. Do not over tighten or damage will occur. In a safe direction fire 2 to 4 shots. Trigger should become very hard to pull or even unable to be pulled. If this occurs, the response trigger system is functioning properly. Go to step 2. If it does not occur, go to Troubleshooting B.

2) Now while firing in a safe direction with marker still unloaded, slowly turn the flow control adjustor counterclockwise until desired rate of fire is achieved.

Tuning - Troubleshooting B:

If the trigger remains easy to pull after adjusting the flow control, there may be a leak in the system. Double check installation making sure all fittings are tight and o-rings are properly seated. If you need to disassemble to check that all fittings are tight and o-rings are properly seated, do not disassemble this marker while it is pressurized with air, follow disassembly / assembly instructions on page 15.

If a problem still exists, call Tippmann™ Service Department at 1-800-533-4831.

NOTE: To disable the Response™ System, remove the universal 90° fitting attached to the power tube/valve and replace it with the shut off plug.



E-TRIGGER™ Battery Installation or Replacement

Before installing air supply, install 9 volt battery (not included).

STEP 1: Prepare the marker for disassembly.

To do so, first follow the unloading and air supply removal instructions on page 14 and never disassemble a marker that is under pressure.

STEP 2: Remove Battery Clip/old battery (from marker).

1) Remove left grip (2 bolts).

2) Carefully work battery out of receiver cutout bringing non-connected end out first. As you remove battery from receiver, do not rip wires off of internal components.

3) Carefully remove old battery from battery clip connector.

STEP 3: Install new battery.

1) Attach 9v battery to battery connector and be sure wires lay flat inside the cutout area of receiver (as shown on page 11).

2) Carefully tilt and insert your new battery, wire attached end first, into receiver as shown.

3) Reinstall left receiver grip with 2 grip bolts.

Battery installation is complete.



E-TRIGGER™ Tuning and Operating Instructions

Familiarize yourself with and follow these instructions to select the firing mode of your choice from the Firing Mode Setting - Firing Response Description options on page 10.

TURNING ON = The E-TRIGGER™ automatically turns on when you pull the trigger.

TURNING OFF = The E-TRIGGER™ automatically turns off after 10 minutes or so of inactivity.

Selecting Firing Mode

Mode Adjustment - Top Access Opening

- With screwdriver, turn the Mode Adjustment switch to select desired firing mode setting on page 10.

Selecting Rate of Fire

Rate Adjustment - Lower Access Opening

- Turn the Rate of Fire Switch clockwise to increase the rate of fire.
- Turn the Rate of Fire Switch counterclockwise to slow the rate of fire.

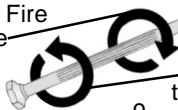

E-TRIGGER™ - Mode Settings / Firing Response

Firing Mode Setting . Firing Response Description:

- 0 = NO OPERATION No response.
- 1 = SEMI AUTO Fires one shot for each pull of the trigger.
- 2 = NO OPERATION No response.
- 3 = AUTO RESPONSE Fires one shot for each pull or release of the trigger. If the trigger is held for an extended period, when the trigger is released no shot is fired.
- 4 = NO OPERATION No response.
- 5 = FULL AUTO Fires shots repeatedly as long as the trigger is held.
- 6 = NO OPERATION No response.
- 7 = 3 SHOT Fires either a 3 shot burst when the trigger is held or if trigger is released before 3 shot cycle is complete - firing stops at that point of cycle.
- 8 = NO OPERATION No response.
- 9 = TURBO Fires one shot for each pull of the trigger until the time between trigger pulls is below .25 seconds - it then goes to one shot for each pull or release of the trigger.

E-TRIGGER™ Troubleshooting

Problem: If you pull the trigger and marker does not fire.

- 1) Check to be sure safety is off.
 - 2) Make sure sufficient air supply is hooked up to marker.
 - 3) Firing Mode may be set to "NO OPERATION".
With screw driver, turn Mode adjustment, access through top hole in lower receiver, turn 1 position (click) try trigger again.
 - 4) Battery may be disconnected - check battery clip connection.
 - 5) Battery may be bad - replace battery.
 - 6) Internal wire may be disconnected. Inspect wire connections inside lower receiver. To do so, first follow the unloading and air supply removal instructions on page 14 and never disassemble a marker that is under pressure. Remove left receiver half as outlined on page 15, then visually inspect internal wires for disconnected wire end(s). When replacing left receiver half, be sure wires are positioned in cutout areas so wires are not pinched or sheared and the armature pin moves freely (follow instructions on page 11).
- If a problem still exists, call Tippmann™ Service Department at 1-800-533-4831.

E-TRIGGER™ Internal Parts Positioned for Reassembly

Do not operate sear tripper assembly uninstalled as solenoid/armature may pinch you.

1) Place solenoid / armature into position in right receiver.

Insert Magnet in slot below armature as shown.

2) Carefully align and insert computer board into slot.

3) Place trigger switch on two pins of right receiver half.

4) Insert capacitor in slot.

5) Route wires in cutout areas to lay flat under armature pin and battery and not be pinched when receiver halves are reassembled.

6) Insert armature pin into 2 slots so it moves freely.

7) Double check that all parts are in place as shown.

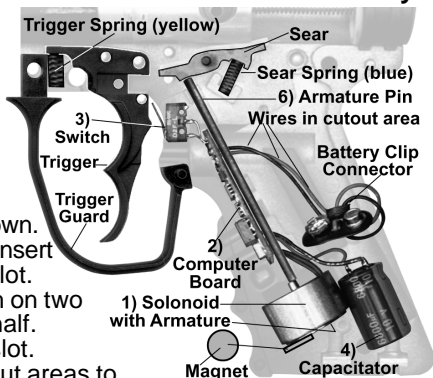

E-TRIGGER™ Reassembling Receiver Halves

1) Double check that all other parts: Front Sight, Front Site Pin, Front Sight Spring, Ball Latch, Front Bolt, Linkage Arm, Rear Bolt, Drive Spring & Guide Pin, Buffer O-ring, End Cap, Rear Sight and Tank Adapter Nuts are place.

2) Place battery connector through left receiver half as you replace left half on right half, don't pinch wires.

3) Make sure halves fit flush and magnet fits into left receiver half slot so it does not break. For ease of installation tighten the bolt over the trigger first. Next reinsert front grip, it gets longest bolt, and tighten 5 remaining bolts.

4) Reinstall tank adapter and reinstall barrel.

5) Attach 9v battery to battery connector and be sure wires lay flat inside the cutout area of receiver, as shown above.

6) Carefully tilt and insert battery, wire attached end first, into receiver.

7) Reinstall left receiver grip with 2 bolts. Reassembly is complete.

You are now ready to tune the E-Trigger™ rate of fire and set the mode of fire as outlined in tuning instructions on page 9.



CUSTOM PRO™ Basic Parts List

Custom Pro™ Response™ Parts (page 17)
Custom Pro™ with E-Trigger™ Parts (page 17)

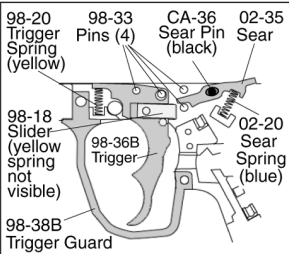
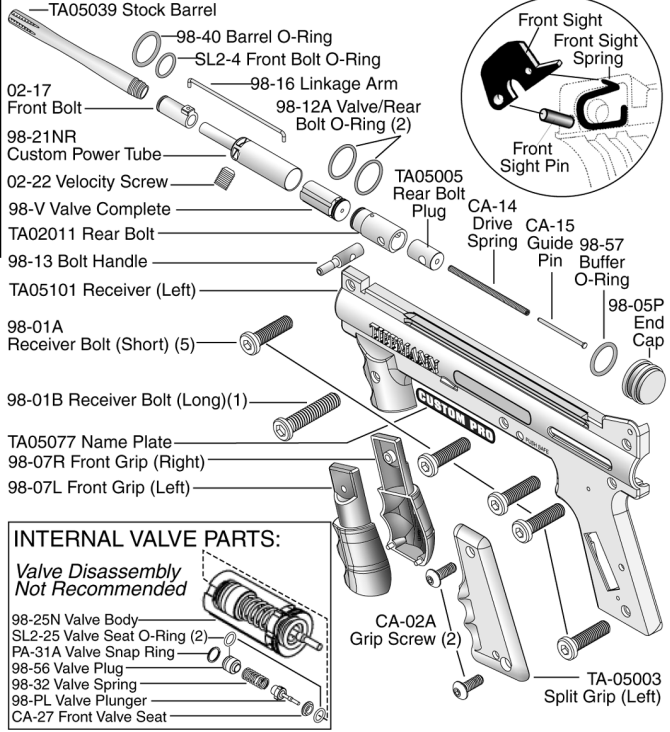

TRIGGER ASSEMBLY

- 1) Place 4 pins and 1 black sear pin into locations as shown.
- 2) Then place the trigger and sear onto pins as shown.
- 3) Insert sear spring (blue) as shown.
- 4) Insert trigger spring (yellow) as shown.



WARNING

DO NOT FIELD STRIP OR OTHERWISE DISASSEMBLE THIS MARKER WHILE IT IS PRESSURIZED WITH AIR.

TIPPMANN™

1-800-533-4831

www.tippmann.com

98-45 Flat Washer

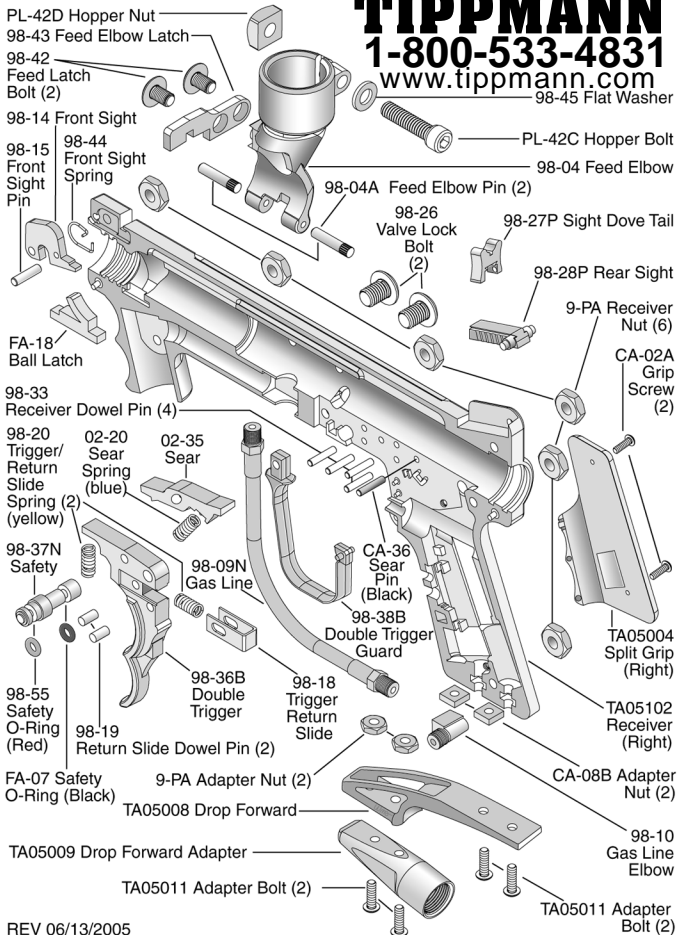

**E
N
G
L
I
S
H**

Unloading Your Marker

To unload your marker remove the hopper or completely empty the hopper. Then, point your marker in a safe direction and fire several times to be sure there are no balls lodged in the chamber and / or barrel. Install barrel sleeve (see page 2).

IMPORTANT: Do not uncock your marker as uncocking your marker may push a ball into the chamber or down into the barrel in which case the ball will be hidden from view.

Air Supply Cylinder Removal

To remove a charged air supply cylinder, turn the cylinder approximately 3/4 of a turn counterclockwise or out. This allows the air supply pin valve to close so that no air will enter the marker. Point the marker in a safe direction and fire the remaining gas in the marker by pulling the trigger until the marker stops firing. This may take 4-5 shots.

If your marker keeps firing after you have turned the tank 3/4 of a turn, the tank pin valve has not closed yet and you may have to turn the tank counterclockwise a little further.

If you turn the tank 3/4 of a turn and it begins to leak before you pull the trigger you have turned it too far and may have damaged the tank o-ring.

Because of the variances in tank valve parts, each tank varies slightly on exactly how far it should be turned. If this process does not work the tank pin valve could be too long.

NOTE: Before storing or disassembling be sure to remove paintballs and air supply. Completely empty the hopper, point your marker in a safe direction, fire several times to be sure there are no balls lodged in the chamber and/or barrel or air left in the marker. Install barrel sleeve (see page 2).

Cleaning & Maintenance

To reduce the chance of accidental discharge: First follow unloading and air supply removal instructions above and never disassemble a marker that is under pressure.

- Follow warnings listed on the air supply cylinder for handling and storage.
 - Familiarize yourself with instructions listed on air supply cylinder or adaptor. Contact the air supply cylinder or adaptor manufacturer with any questions.
 - Do not use any petroleum based cleaning solvents.
 - Do not use any cleaning solvents that come in aerosol cans.
- NOTE:** Petroleum based products and aerosol products can damage your markers' o-rings.
- To clean your paintball marker use a damp towel with water to wipe off paint, oil, and debris. We recommend using Tippmann™ marker oil or other premium gun oil to maintain your marker in good working condition. Re-oil with a few drops to the front bolt o-ring and rear bolt. We also

recommend using Tippmann™ marker oil or other premium gun oil on the barrel o-ring and air supply valve o-ring.

- To clean the barrel. Depress front sight and tip out feed elbow. Insert metal tab of cable squeegee into breach, then pull squeegee through barrel to remove debris.

Marker Disassembly

First follow unloading and air supply removal instructions on page 14. Do not pressurize a partially assembled paintball marker. Put the marker in the uncocked position. If your marker is cocked, hold the bolt handle while pulling the trigger which will uncock the marker.

NOTE: The barrel (1) and adapter bolts (2-3) must be removed first. Next, turn the velocity screw in until it stops.



To remove the left-side receiver, unscrew bolts (4-9) receiver connection bolts. Then carefully lift the left-side receiver to access the internals.

NOTE: The Safety will stay on the left-side receiver and should be reassembled the same way.

Once inside, pull the end cap out to remove the guide pin and drive spring. These parts must be removed before the bolt handle will release. Disconnect the linkage arm from the rear and front bolts. Slide the front bolt off the power tube and check the o-ring. Clean and oil the o-ring or if damaged, replace with a new one. Do the same with the rear bolt o-ring.

Power tube and valve removal.

NOTE: Do not remove the gas line fitting unless it is leaking or you need to replace the valve. If you should do so you will need some teflon tape or paste to reinstall it.

- First, you need to complete Marker / Receiver Disassembly Instructions on page 15.
- Removal: To release the power tube and valve, unscrew the two valve lock bolts on the outer right-side receiver.
- Installation: Apply red loctite to bolts threads and do not over tighten valve lock bolts and strip threads when reinstalling.

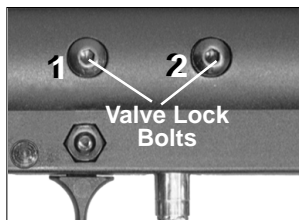

Valve removal from power tube: If it is necessary to remove the valve, use a wrench to slowly unscrew the gas line fitting. Once the fitting is out, the valve will slide out the back of the power tube.

NOTE: Check the external valve o-ring at this time. If the o-ring is damaged your marker will not function correctly.

Reinstalling valve: Insert valve into power tube, align holes and add teflon tape or paste to gas line fitting threads, slowly screw into valve and snug with wrench.

Repairing Air Supply Cylinder Leaks

The most common leak occurs from a bad air supply valve o-ring. To replace a valve o-ring you must first remove the bad o-ring and then install a new one. This o-ring is located on the tip of your air supply valve. The best valve o-rings are made of urethane. The urethane o-rings are not affected by high air supply pressures. These may be purchased from Tippmann™ or your local paintball dealer.

NOTE: If new valve o-ring does not resolve air supply leak, do not attempt to repair air supply cylinder. Contact Tippmann Sports, LLC or your local paintball dealer.

Storage

Before storage unload and remove air supply (see page 14). Then install Barrel Sleeve (see page 2) and put your marker in Safe Mode (see page 4). You should store your marker in a dry area. Before storing your marker make sure that the marker is cleaned and oiled (see cleaning and maintenance on page 14) so that it does not rust. Store your marker with the bolt in the forward position, uncocked.

Storage (continued from page 16)

When removing your marker out of storage make sure Barrel Sleeve is installed (see page 2) and safety is in Safe Mode (see page 4). You should re-oil the rear bolt and the front bolt o-ring before use.

Specifications

Model Basic Tippmann™ CUSTOM PRO™
 Caliber68
 Action Semi-Automatic (open bolt blow-back)
 Power/Air Supply compressed air, nitrogen or CO2
 Hopper Capacity 200 Paintballs
 Cycle Rate 8 shots per second
 Standard Barrel Length 11"
 Overall Length (with standard barrel & no tank) 21"
 Weight (without tank) 2.9 lbs.
 Effective Range 150+ ft.
 Velocity Always measure your marker's velocity before playing paintball and never shoot at velocities in excess of 300 feet per second (see instructions on page 7).

Model Specific Tippmann™ CUSTOM PRO™ RESPONSE™
 Cycle Rate 15 shots per second
 Weight (without tank) 3.05 lbs.

Model Specific..Tippmann™ CUSTOM PRO™ WITH E-TRIGGER™
 Cycle Rate 17 shots per second
 Weight (without tank) 3.19 lbs.

Model Specific Parts Not Shown on CUSTOM PRO™ schematic.

CUSTOM PRO™ RESPONSE™

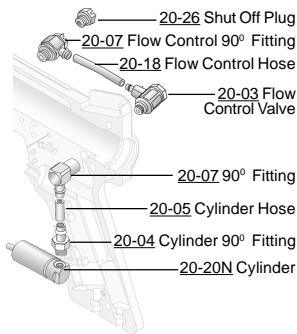

CUSTOM PRO™ WITH E-TRIGGER™

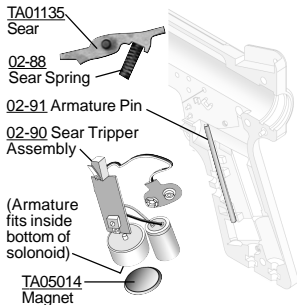

WARRANTY AND REPAIR POLICY

Tippmann Sports, LLC warrants that this product is found free from defects in materials and workmanship for a period of 1 year from the original date of purchase by the initial owner/purchaser. This warranty does not apply to defects discovered after purchase which were caused by the unauthorized modifications and alterations of our product. Tippmann Sports, LLC will repair or replace, without charge, any of its markers that have failed through defect in material or workmanship. Tippmann is dedicated to providing you with the ultimate paintball marker and the quality support necessary for satisfactory play.

WARRANTY OR REPAIR PROCEDURE

If you should encounter any problems with your marker and you have aftermarket parts on your marker, please test it with the original stock parts before sending it in.

Always unload and remove air supply before shipping a marker. Do not ship your air supply tank if it is not completely empty.

For warranty and non-warranty repair:

1. Ship or deliver your product(s) to:
Tippmann Sports, LLC
2955 Adams Center Road
Fort Wayne, IN 46803
2. Postage or delivery charges must be prepaid.
3. Include a brief statement regarding the requested repair, your name, return address and telephone number where you can be reached during normal business hours, if possible.

Our policy is to complete the necessary repair work within 24 hours and return it to you via regular ground UPS. If you wish to have it returned using a faster service, you can request for NEXT DAY AIR UPS OR SECOND DAY AIR UPS. You will be charged for this service and must include your credit card number with the expiration date. Your card will be charged the difference in additional cost over regular ground shipping service.

WARRANTY REGISTRATION

Register your marker either:

1. On line at www.tippmann.com.
2. Complete attached registration card and mail to the above address.



TIPPMANNTM

2955 ADAMS CENTER ROAD
FT. WAYNE, IN 46803 USA

Warranty Registration online at www.tippmann.com
or complete this warranty card and mail to Tippmann.

Check Model: CUSTOM PROTM

CUSTOM PROTM RESPONSETM

CUSTOM PROTM WITH E-TRIGGERTM

Serial Number (above left front grip).

#

Purchased from

Date

City

State

Zip

Country

Your Name (print)

Age

Male

Female

Address

City

State

Zip

Country

Phone #

Email

TIPPMANN™

2955 ADAMS CENTER ROAD
FT. WAYNE, IN 46803 USA

Registro de Garantía via On line a www.tippmann.com
o complete esta tarjeta de garantía y envíandola por correo regular a Tippmann.
L'inscription de Garantie sur l'internet à www.tippmann.com ou
complétez la carte de d'inscription et l'envoyez à Tippmann.



Check Model: CUSTOM PRO™ CUSTOM PRO™ RESPONSE™ CUSTOM PRO™ WITH E-TRIGGER™

Número de Serie (Número sobre apretón izquierdo delantero).
Número Sérial (Nombre au-dessus de poignée avant gauche).

#

Nombre comprador
Acheté du

Decha
Date

Ciudad
Ville

Estado
Etat

Código Postal
Code Postale

País
Pays

Nombre (letra de molde)
Votre nom

Edad
Age

Hombre
Mâle

Mujer
Femelle

Dirección
Adresse

Ciudad
Ville

Estado
Etat

Código Postal
Code Postale

País
Pays

Teléfono
No. de téléphone

Email

THIS PAGE INTENTIONALLY LEFT BLANK

TIPPMANN™
**CUSTOM
PRO™**
MARKERS

Owner's Manual
Le Manuel du
Propriétaire
Manual del
Usuario

**CUSTOM
PRO™**



**CUSTOM
PRO™**
CAMOUFLAGE



**CUSTOM
PRO™**
RESPONSE™



**CUSTOM
PRO™**
**WITH
E-TRIGGER™**

